

INSTALLATION MANUAL

Thank you for purchasing our high quality product!

M1-20

GENERAL INFORMATION

This product must be installed by a qualified plumber.

Not suitable for using with gravity-fed systems.

To ensure optimum performance and customer satisfaction please adhere to the following:

ALL PIPEWORK MUST BE THOROUGHLY FLUSHED PRIOR TO INSTALLATION OF THE MIXER. AN INLINE FILTER MUST BE FITTED TO PREVENT FOREIGN PARTICLES DAMAGING THE CERAMIC CARTRIDGE.

Installation should comply with relevant local authority requirements.

Operating Temperature: Hot - Maximum 75°C Cold - Minimum 5°C

NB: New Zealand Building Code Clause G12 - Water Supplies specifies all outlets used primarily for personal hygiene shall deliver water at a safe temperature

-Recommended minimum working pressure 150kPa.

-Recommended maximum working pressure 500kPa.

If the water pressure exceeds or is likely to exceed 500kPa, an approved pressure limiting valve must be fitted.

If the water temperature exceeds 75°C, an approved tempering valve must be fitted.

ECOFLOW, CORA, LINEAR, S2, WAIWERA, ELEGANCE,

OXFORD, ECO, RHODES LOW PRESSURE Operating Pressure:

Min: 35kPa, Max: 1000kPa

Recommend 150-500kPa

Recommended installation of a pressure limiting valve if supply pressure exceeds 500kPa

Unequal Low Pressure: If your hot water pressure is low or has a greater difference than 150kPa compared to your cold water, You will require a pressure reducing valve or a flow restrictor to make the hot and cold-water pressure equal. This needs to be done to help your faucet mix water more evenly and will result in providing variable temperature control.

Low pressure will not be suitable for shower diverter mixers, or mixers with multi spray features.

INSTALLATION MANUAL



Pipe tape



Allen key



Philips screwdriver



Adjustable wrench



Plastic screw spanner

Basin Mixer

- 1** The hole dimension as 35mm.

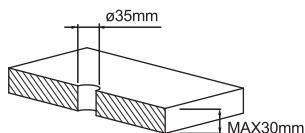

- 3** As shown in the figure connect the flexible hoses. (Notice to distinguish red & blue mark).

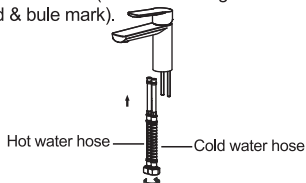

- 5** Attach two flexible hose to water supply. Take out the aerator from the spout and flush the mixer.

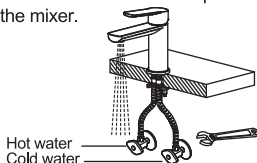

- 2** Fix the bolts to the bottom of body, tighten it by screwdriver.



- 4** Install base ring, plastic washer, metal washer, and the flow restrictor to the cold supply.

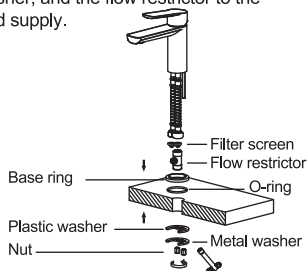

- 6** Mixer Operation

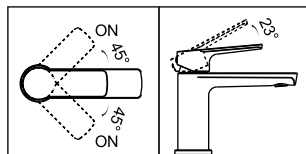

Basin Mixer

1

The hole dimension as 35mm.

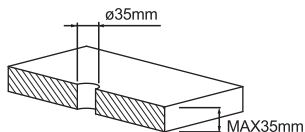

2

As shown in the figure connect the flexible hoses. (Notice to distinguish red & blue mark).



3

Install o-ring, plastic washer, metal washer and black plastic nut.

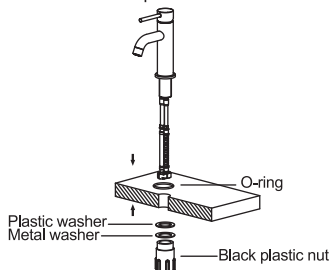

4

Install the flow restrictor to the cold supply.

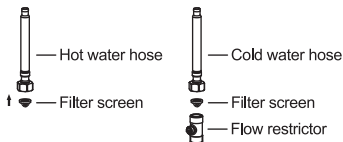

5

Attach two flexible hose to water supply. Take out the aerator from the spout and flush the mixer.

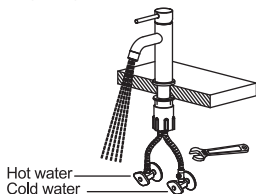

6

Mixer Operation

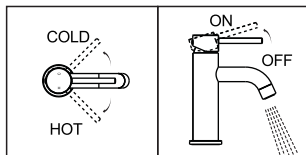

Concealed Wall Basin Mixer

- 1** Put the body into the hole and tighten. Fix the body on wall.

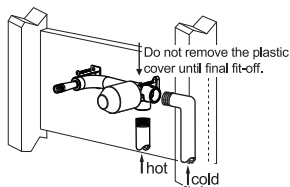

- 2** The depth of the wall

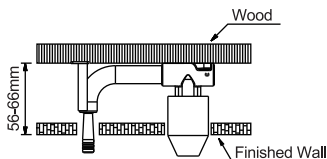

- 3** Remove the plastic covers carefully.

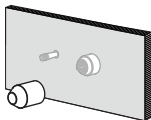

- 4** Put the cover plate to the bath spout slowly and carefully. Put the bath spout on the body and tighten by allen key. Push the cover plate to the wall.

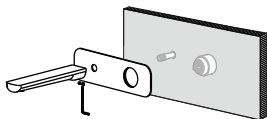

- 5** Install the handle, tighten with allen key, and fit the button into handle.

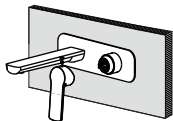

- 6** Mixer Operation

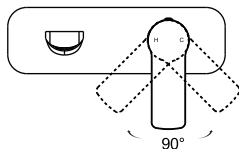

Pull-out Kitchen Mixer

- 1** The hole dimension as 35mm.

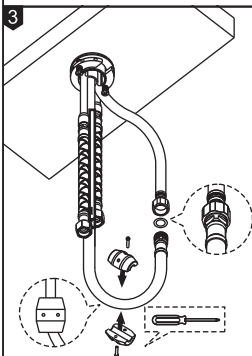
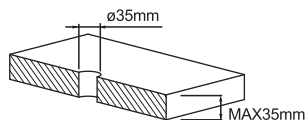

Please ensure the sprayer hose to the lowest point and assemble the supply hoses with the sprayer hose. Attach the metal ball at the bottom of the sprayer hose with two screws supplied.

Reposition the hose weight as necessary to insure the handspray pulls out and retracts smoothly.

- 2** Install the flexible hose to the faucet body. Put the Body to the round hole.

Pass the Washer, Stainless Steel Sheet and Brass Nut through the Threading Rod. Tighten the Brass Nut by Screwdriver.

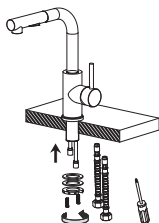

- 4** Install filter screens. Attach two flexible hose to water supply.

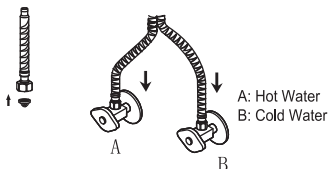

- 5** **Mixer Operation**

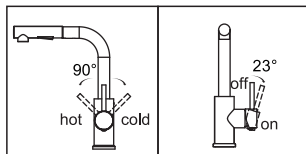

Concealed Shower Mixer

- 1** Put the body into the hole and tighten.
Fix the body on wall.

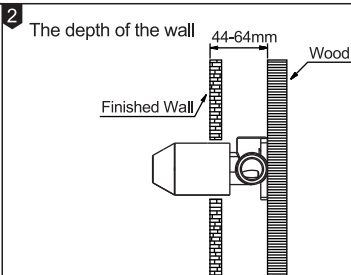
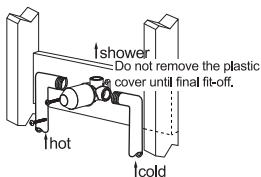

- 3** Remove the plastic covers carefully.

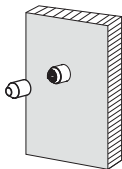

- 4** Put the cover plate on the body slowly and carefully.

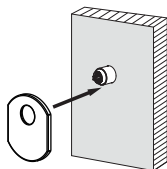

- 5** Install the handle and hot & cold button, then tighten with allen key.

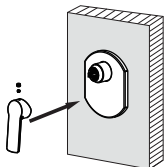

- 6** **Mixer Operation**

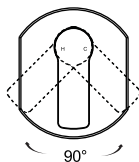

Concealed Bath-Shower Mixer

- 1** Put the body into the hole and tighten.
Fix the body on wall.

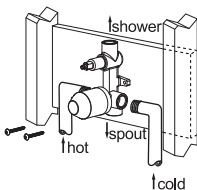

- 3** Remove the plastic covers carefully.

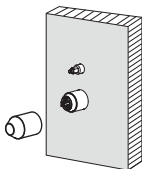

- 5** Put the diverter to the mixer body.
Install the handle and hot & cold button,
then tighten with allen key.

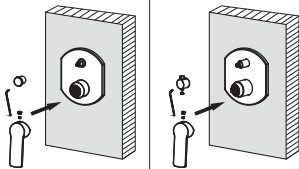

- 2** The depth of the wall

THIN PANEL 54-64mm

THICK PANEL 54-60mm

THIN PANEL 56-75mm

THICK PANEL 56-70mm

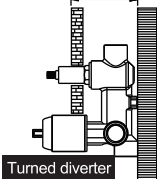
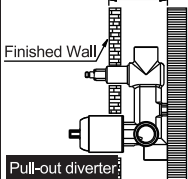

- 4** Put the cover plate on the body slowly
and carefully.

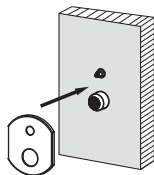

- 6** Mixer Operation

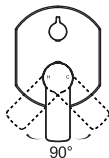
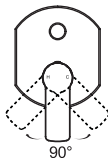

Double Handle Concealed Basin Mixer

- 1** Disassemble hot water and cold water cartridges. Separate the protective cover, cartridge, washer and nut lock individually.

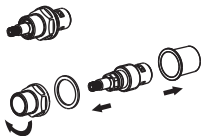

- 2** ① Assemble the hot water cartridge and cold water cartridge to corresponding body by plier.
② Assemble the red washer and blue washer onto corresponding cartridges. Afterwards, fasten the nut lock.

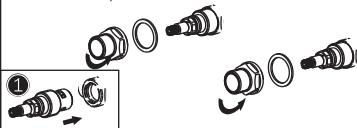

- 3** Assemble handle base and o-ring onto hot water cartridge and cold water cartridge respectively.

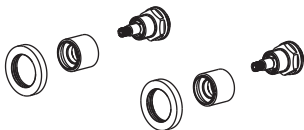

- 4** Put the bath spout on the body and tighten by allen key. Push the cover plate to the wall.

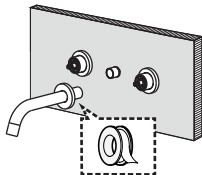

- 5** Sparate the screw and handle lever from the handle knob. Put the handle knob to the mixer body. Fix the screw to the handle knob and mixer body by allen key. Fix the O-ring to the handle lever, then tighten the handle lever to the handle knob.

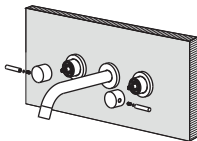

- 6** **Mixer Operation**



Shower Tower

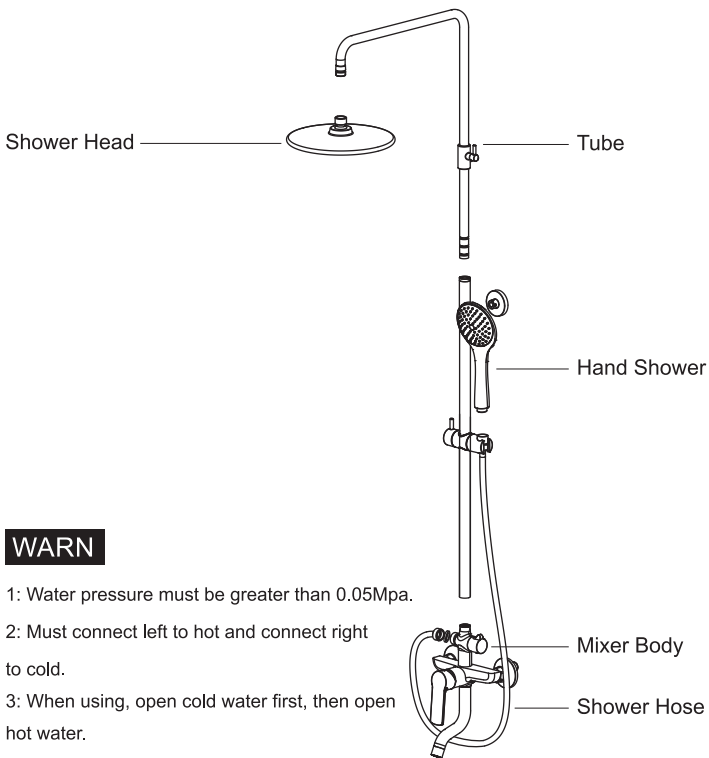

WARN

- 1: Water pressure must be greater than 0.05Mpa.
- 2: Must connect left to hot and connect right to cold.
- 3: When using, open cold water first, then open hot water.

1 Eccentric installation

Flush the pipe, wrap the eccentrics with the tape and install it to the water outlet. Ensure the two eccentrics to be horizontal.

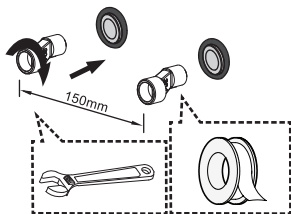

2 Rosette installation

Screw the rosettes to the eccentrics.

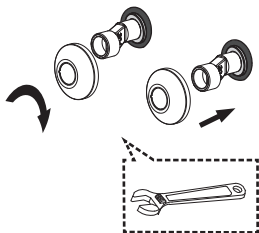

3 Slider, tube and wall bracket installation

- Put the straight tube through the slider.
- Install the bended tube to the straight tube.
- Put the wall bracket to the tube and fix it by allen key.

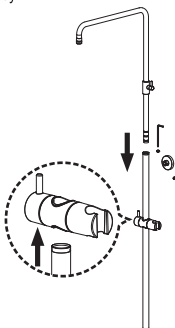

4 Body and tube installation

Connect and screw the body to the straight tube.

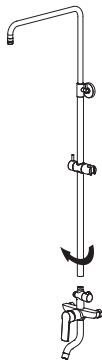

5 Overview

Put the body to the eccentrics and keep the tube vertical. (Remark: make a mark to the wall for the bracket)

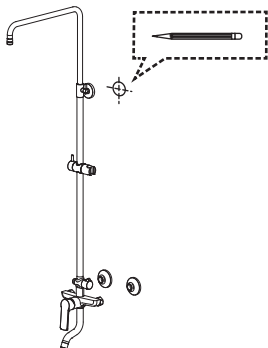

6 Remove the bracket

Remove the bracket from the tube.

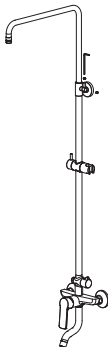

7 Wall bracket plate Installation

Drill the hole to the maked wall, hammer the rubber plug into the hole. Fix the wall bracket plate and tighten the screw by electric drill.

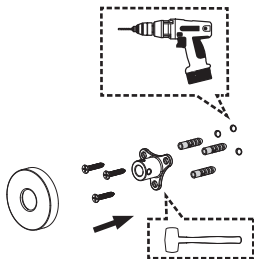

8 Wall bracket and body installation

Tighten the bracket by allen key, Put the washer to the body hexagon nut and tighten the body to the eccentric.

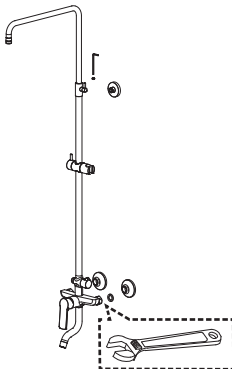

9

Flush the pipe

Turn on the handle to flush the pipe.

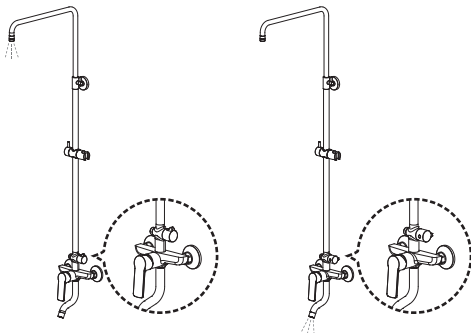

10 Shower head, hand shower and shower hose installation

- Turn the shower head to the tube.
- Turn the hand held shower to the shower hose, make sure the washer is inside the hose connector.

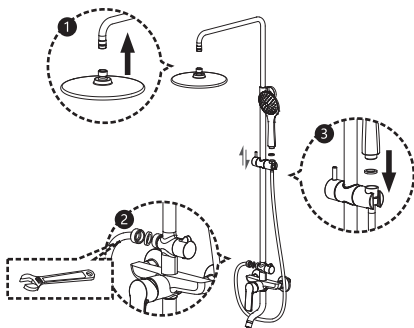

Installation Completion Chart



Shower Tower

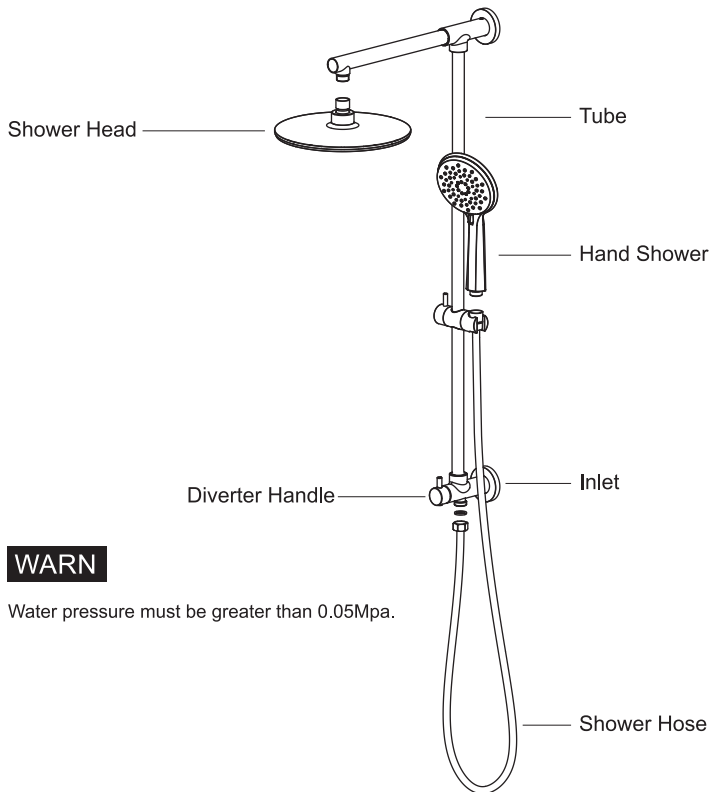

WARN

Water pressure must be greater than 0.05Mpa.

1 Setting-out

Draw a line with the leveling instrument and keep it vertical, then make a mark at a distance of 800mm from the water inlet. Put the wall bracket plate aligning at the mark, and make a mark at two points.

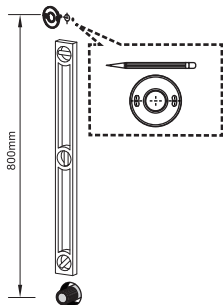

2 Fix the Bracket Plate

Drill a hole to the marked wall, hammer the rubber plug into the hole. Fix the wall bracket plate and tighten the screw by phillips screwdriver.

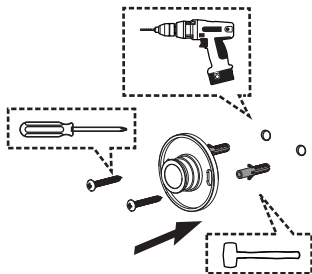

3 Install the Dual Check Valve Connector

Wrap the water inlet with the tap and fix the connector to the wall, then tighten the connector by allen key.

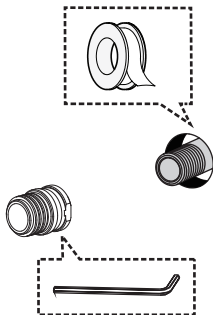

Installation Completion Chart



1 Setting-out

Draw a line with the leveling instrument and keep it vertical, then make a mark at a distance of 800mm from the water inlet. Put the wall bracket plate aligning at the mark, and make a mark at two points.

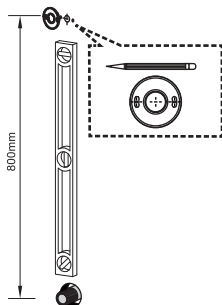

2 Fix the Bracket Plate

Drill a hole to the marked wall, hammer the rubber plug into the hole. Fix the wall bracket plate and tighten the screw by phillips screwdriver.

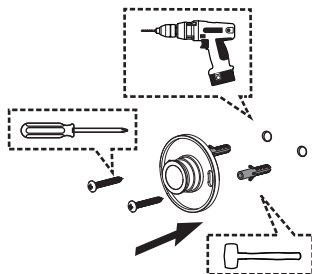

3 Install the Dual Check Valve Connector

Wrap the water inlet with the tap and fix the connector to the wall, then tighten the connector by allen key.

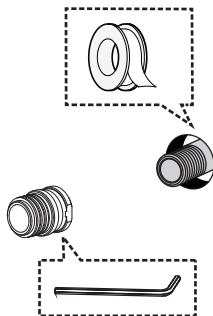

Installation Completion Chart



4 Install the Tube

Install the horizontal tube to the straight tube and tighten it by the allen key.

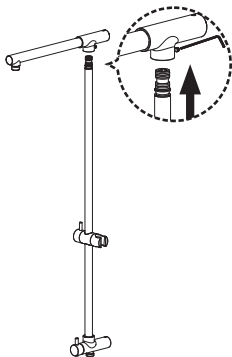

Installation Completion Chart

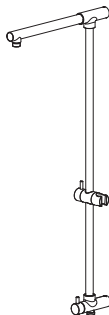

5 Install the flange

Put the flange to the horizontal tube and the dual check valve, then tighten it by allen key. Put the flange to the wall.

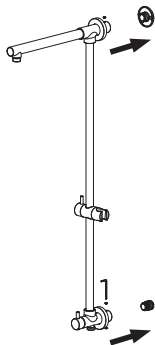

Installation Completion Chart

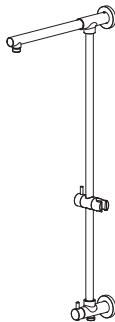

6 Flush the Pipe

Turn on the diverter handle, to flush the pipe.

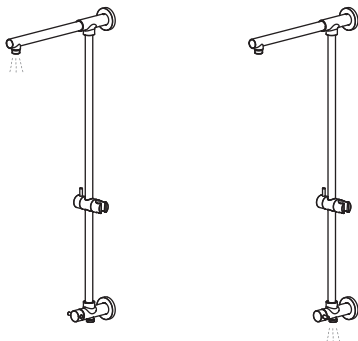

7 Install the Shower Head , Hand Shower and Shower Hose

- Turn the shower head to the tube.
- Turn the shower hose to the dual check valve, make sure the washer is inside the hose.
- Turn the hand-held shower to the shower hose, make sure the washer is inside the hose.

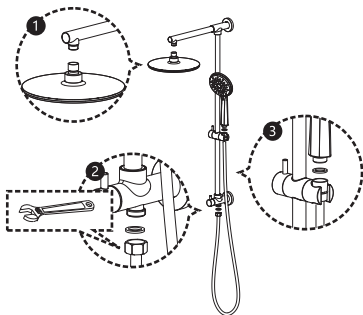

Installation Completion Chart

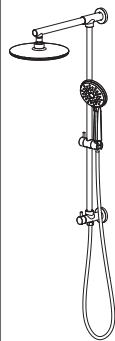

Floor Bath Filler

- 1 Gently put the plate cover onto the pipe vertically to avoid scratch. Screw and tighten the base as figure shown.

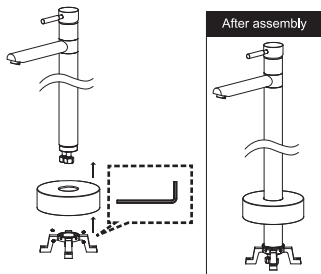

- 2 Adjust the direction of the base to the holes vertically. Mark the position of 4 holes on the ground by pencil.

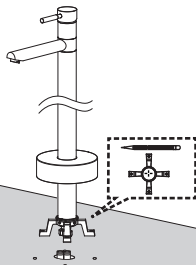

- 3 Drill holes to the marks on the ground. Put in the expanding nut afterwards.

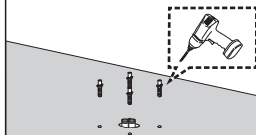

- 4 Tighten inlet hose by adjustable wrench. (Ensure hot & cold inlet hose attach to the correct direction)

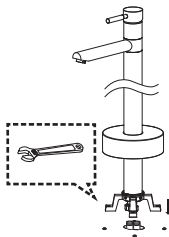

5

Make sure the spout is in front of the bath faucet, then tighten it with the screw.

After assembly

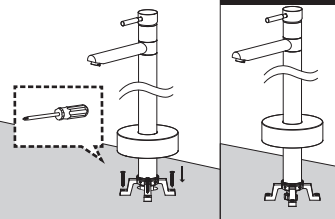

6

Turn on the water supply and make sure it is not leaking. Then put the cover on the ground as the figure shown.

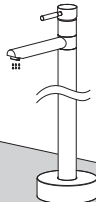

Bath Spout

1

Wrap the water inlet with the tape and fix the valve.

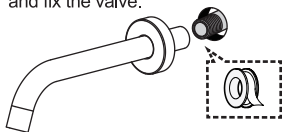

2

Push the cover plate to the wall.

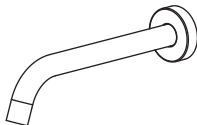

Valve

1

Wrap the water inlet with the tape and fix the valve.

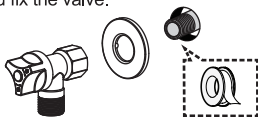

2

Push the cover plate to the wall.



Shower Head

1

Teflon tape twines around the G1/2 connector.

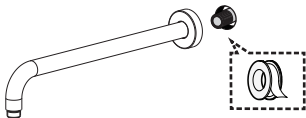

2

Install the overhead shower with shower arm and tighten.

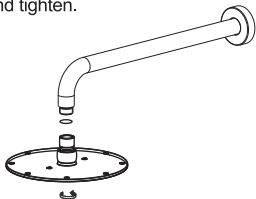

WARRANTY TERMS

All products are guaranteed as follows.

1. 5 years guarantee against casting defaults and porosity;
2. 3 years guarantee against cartridge and valve defaults;
3. 12 months guarantee on washers and O-rings;
4. 12 months guarantee on finish.

MAINTENANCE AND CARE

Chrome plated surfaces should be regularly cleaned with mild liquid detergent or soap and water.

Do not use cream cleaners, as they are abrasive or bleaches.

Do not use cleaning agents containing a corrosive acid or scouring agent.

Use of unsuitable cleaning agents may damage the surface.

Any damage caused in this way will not be covered by warranty.

Failure to comply with the above may avoid all warranties.

This warranty covers only manufacturing defects and is limited to free replacement of products or components.(exclude consequential losses)